



ProTee VX Protective Case Instructions

Protective
Case Bracket



ProTee VX
Ceiling Mount

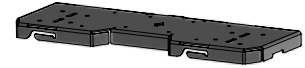

ProTee VX

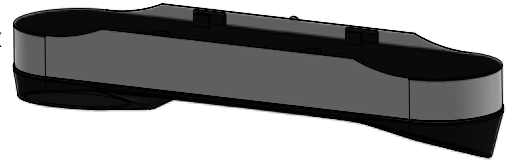

Protective
Case

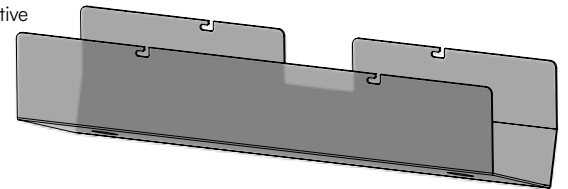

- 1** Pull back the locking pin from the ProTee VX. Slide and remove the ProTee VX ceiling mount.

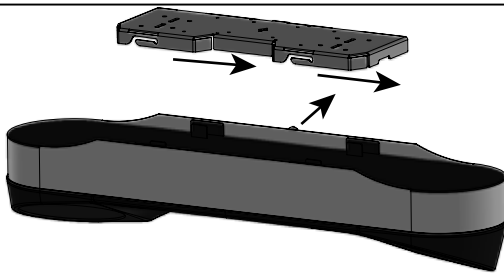

- 2** Attach ProTee VX ceiling mount to the protective case bracket using the long screws and oval nuts from the protective case kit.

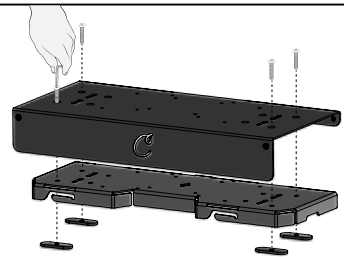

Illustrations in step 3 are shown from the rear.

3 IF CEILING MOUNTING...

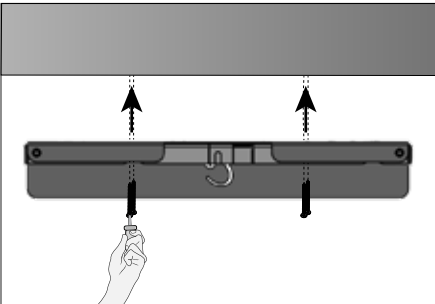

Following ProTee's instructions for mounting your VX, install the mount/bracket combo to the ceiling.

IF USING CARL'S DROP MOUNT KIT...

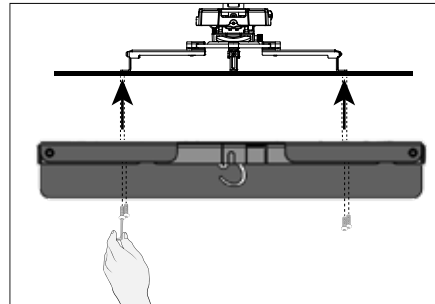

After installing your launch monitor base plate according to your drop mounting kit instructions, install the mount/bracket combo using the small screws from your drop-mount kit.

IF USING CARL'S FRAME MOUNT KIT...

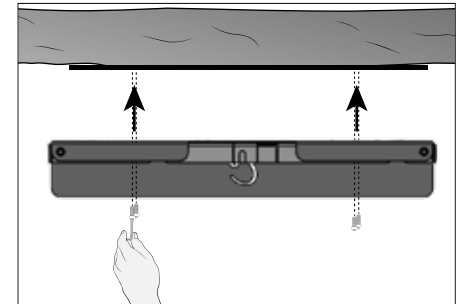

After installing your launch monitor base plate according to your frame mounting kit instructions, install the mount/bracket combo using the small screws from your frame-mount kit.

4

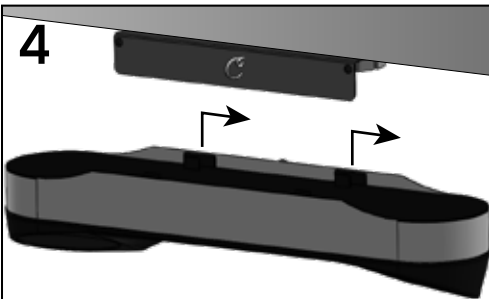

Install the ProTee VX, making sure it is properly aligned. Pull back the locking pin on the rear of the ProTee VX, then slide the unit into the mount until the pin clicks into place and locks it into position.

5

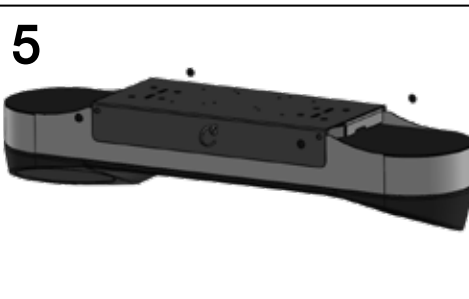

Use the short screws from the protective case bracket to secure the ProTee VX, leaving enough room for protective case to slide in place.

6

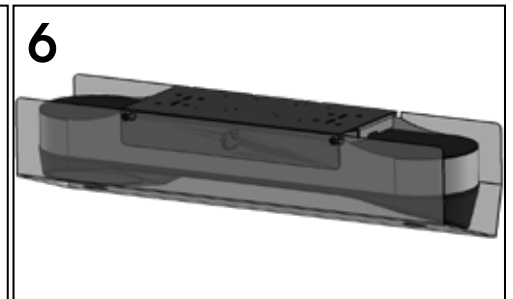

Slide protective case in place, then gently tighten the screws. **DO NOT OVERTIGHTEN.**

Questions? Send us an email at help@carlofet.com or give us a call at (608) 352-0002.