

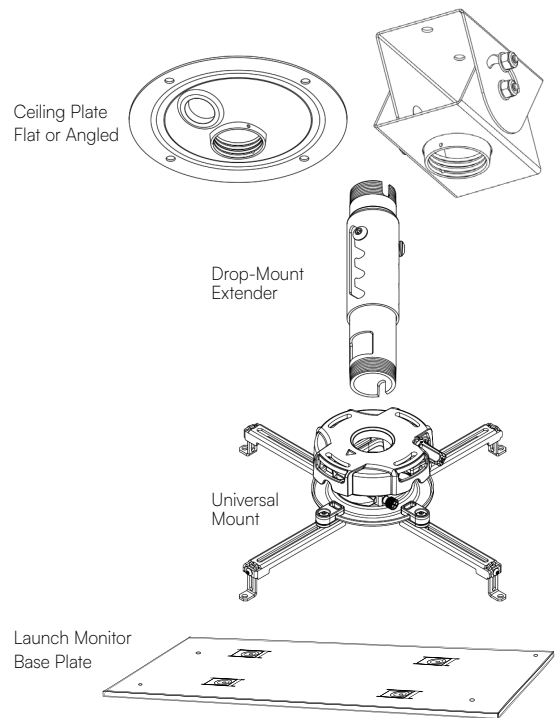

Launch Monitor Ceiling Drop-Mount Quick Start Guide

This setup combines versatile components designed to work together for a secure drop-mount system.

Because each part is adaptable for various mounting applications, you will have extra parts—totally normal and not because you ignored the instructions. Just be sure to reference each component's instructions individually for complete assembly guidelines.



1 INSTALL THE CEILING PLATE

Position the ceiling plate where you want the launch monitor, making sure the location lines up with a ceiling stud. Mark the screw holes through the plate. Drill screws into the stud.

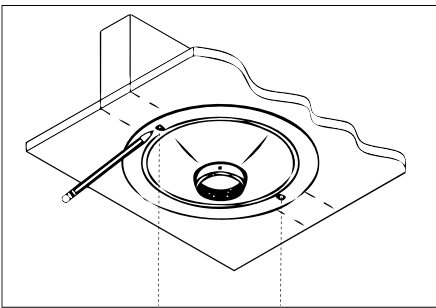

FOR FLAT CEILING PLATE...

The other offset hole can be used to route cables if needed.

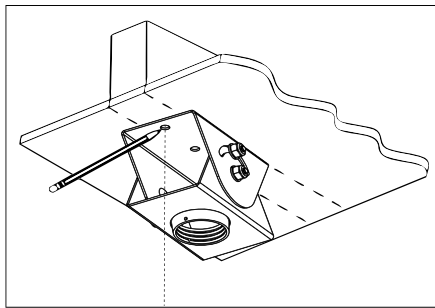

FOR ANGLED CEILING PLATE...

Loosen the tilt bolt to level the mount on the angled ceiling, then tighten.

This quick guide shows the big picture how everything fits together.

For part-specific steps, read and follow the manuals that come with each component.

2

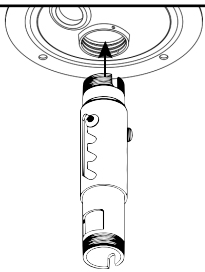

Thread the drop-mount extender into the central hole of the ceiling plate until secure.

3

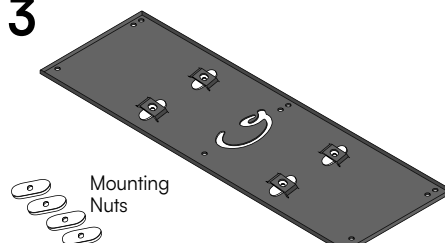

Next, insert the mounting nuts into the bridge lances of the base plate.

4

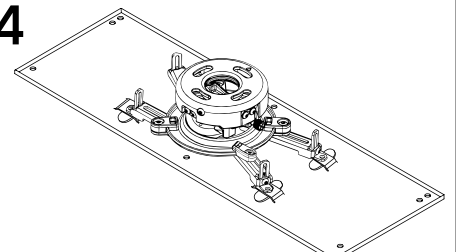

Position the feet of the universal mount over the mounting nuts. Attach them with the M5 screws that are included with the universal mount.

5

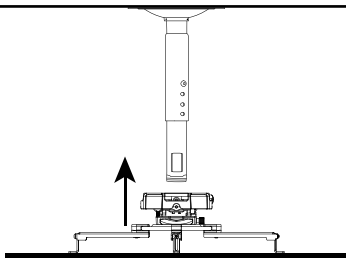

Then screw that combination onto the bottom of the drop-mount extender.

6

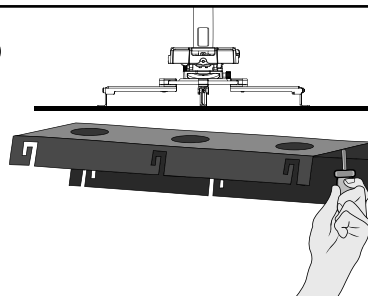

Secure your launch monitor's ceiling bracket to the base plate with the small screws included with the base plate.

7

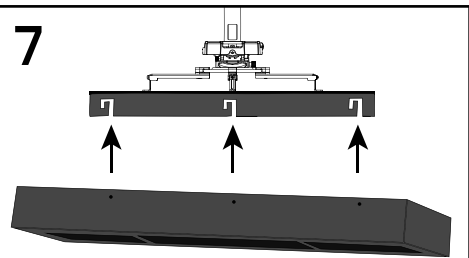

Hang the launch monitor from the bracket. Use a level to make sure it is aligned and secure it in place.

Questions? Send us an email at help@carlofet.com or give us a call at (608) 352-0002.